



# Harewood Close, Hall Green

## £1,100 Per Month



## FLOOR PLAN

Please note that all measurements and floor plans are approximate and quoted for general guidance only and whilst every attempt has been made to ensure accuracy, they must not be relied on and do not form part of any contract.

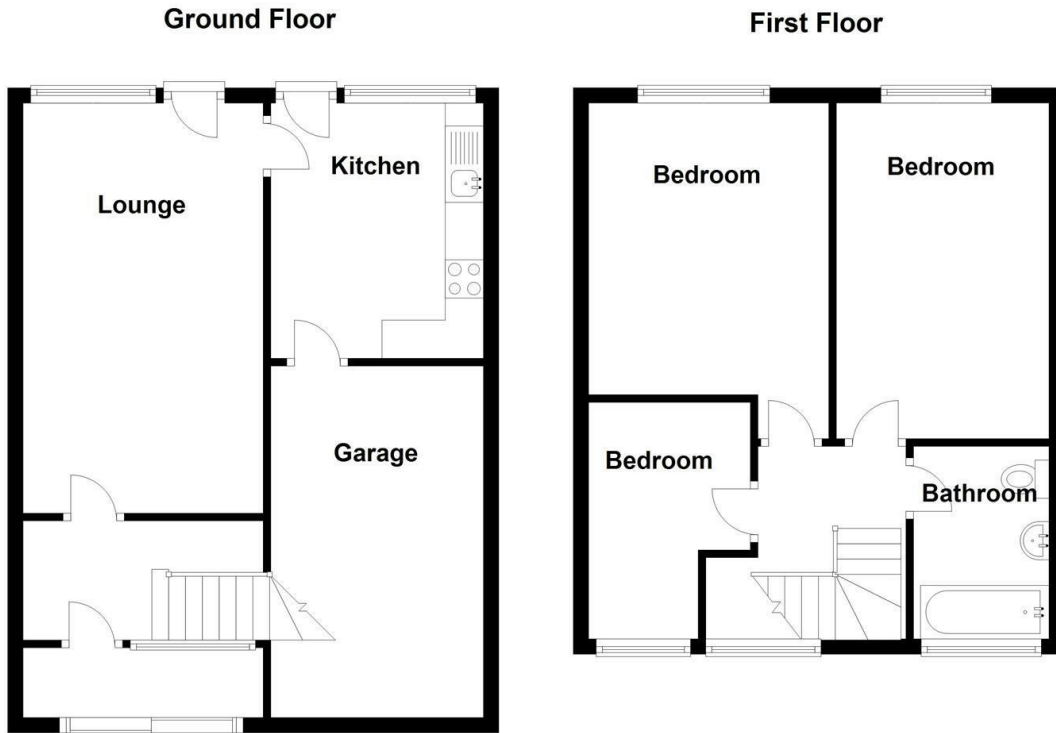

Total area: approx. 90.6 sq. metres (975.2 sq. feet)

Council tax band C

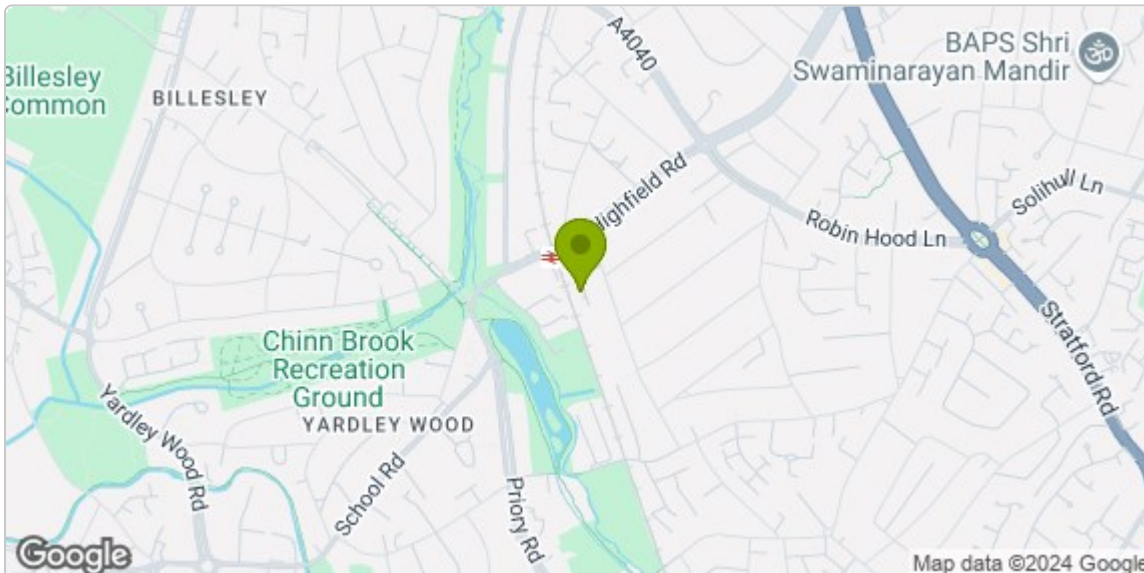

Full Postal Address:  
21 Harewood Close Hall Green  
Birmingham B28 0RX

Council Tax Band: C

Energy Efficiency Rating		
	Current	Potential
Very energy efficient - lower running costs		
(92 plus) <b>A</b>		
(81-91) <b>B</b>		79
(69-80) <b>C</b>		
(55-68) <b>D</b>	61	
(39-54) <b>E</b>		
(21-38) <b>F</b>		
(1-20) <b>G</b>		
Not energy efficient - higher running costs		
England & Wales	EU Directive 2002/91/EC	

387 Stratford Road, Shirley, Solihull, B90 3BW

Tel: 0121 733 7334 Email: [lettings@melvyndanes.co.uk](mailto:lettings@melvyndanes.co.uk) [www.melvyndanes.co.uk](http://www.melvyndanes.co.uk)