



# Ash Crescent, Hillcrest Park

## Offers Around £160,000

- LARGER STYLE
- DINING ROOM
- TWO DOUBLE BEDROOMS
- SIDE & REAR GARDENS
- OVER 50'S
- LOUNGE
- KITCHEN
- BATHROOM WITH SHOWER
- DRIVEWAY
- NO UPWARD CHAIN

Situated on this popular park home site for the over 50's at Hillcrest Park in Wythall, this two bedroom property offers affordable accommodation with parking and a pleasant view to the rear.

There is the benefit of local shops at nearby Drakes Cross Parade in Hollywood, Becketts farm shop is within walking distance and is in close proximity to the Alcester Road in Hollywood which in turn provides access to the M42 motorway and beyond.

The property is situated with easy access to Shirley along Truemans Heath Lane and one can continue back through Hollywood to Sainsbury's at the Maypole island, which also provides access to Birmingham city centre and the southern Birmingham suburbs, along with the Hollywood by-pass which links to the M42, forming the hub of the national motorway network.

There are railway stations nearby at Wythall and Whitlocks End offering commuter services between Birmingham and Stratford upon Avon, and local bus services provide access to the City of Birmingham.

Set back from the road via a front tarmac driveway, a walled and gated side garden gives access to steps to a UPVC door opening into the

### **KITCHEN** **16'8 x 9'8 (5.08m x 2.95m)**



Having wall and base units with work surfaces over, sink and drainer, four ring gas hob with extractor over, space for washing machine and fridge freezer, ceiling light point, central heating radiator, UPVC double glazed window and door to the side and door into the

### **INNER HALLWAY**

Having ceiling light point and doors to two double bedrooms, bathroom and

### **DINING ROOM** **11'7 x 9'11 (3.53m x 3.02m)**



Having UPVC double glazed bow window to eh side, ceiling light point, storage cupboards and door into the

### **LOUNGE** **19'6 x 13'6 max (5.94m x 4.11m max)**



Having UPVC double glazed windows and door to the front and side, two ceiling light points, two central heating radiators and fireplace with inset gas fire



**BEDROOM 1**  
**14'6 x 9'8 (4.42m x 2.95m)**



Having UPVC double glazed window to the side, ceiling light point and central heating radiator

**BEDROOM 2**  
**10'11 x 9'9 (3.33m x 2.97m)**

Having UPVC double glazed window to the rear, ceiling light point and central heating radiator

**BATHROOM**



Having shower enclosure, small bath, low level WC, wash hand basin in vanity unit, ceiling light point, central heating radiator and UPVC double glazed window to the side

**SIDE & REAR GARDENS**



## FLOOR PLAN

Please note that all measurements and floor plans are approximate and quoted for general guidance only and whilst every attempt has been made to ensure accuracy, they must not be relied on and do not form part of any contract.

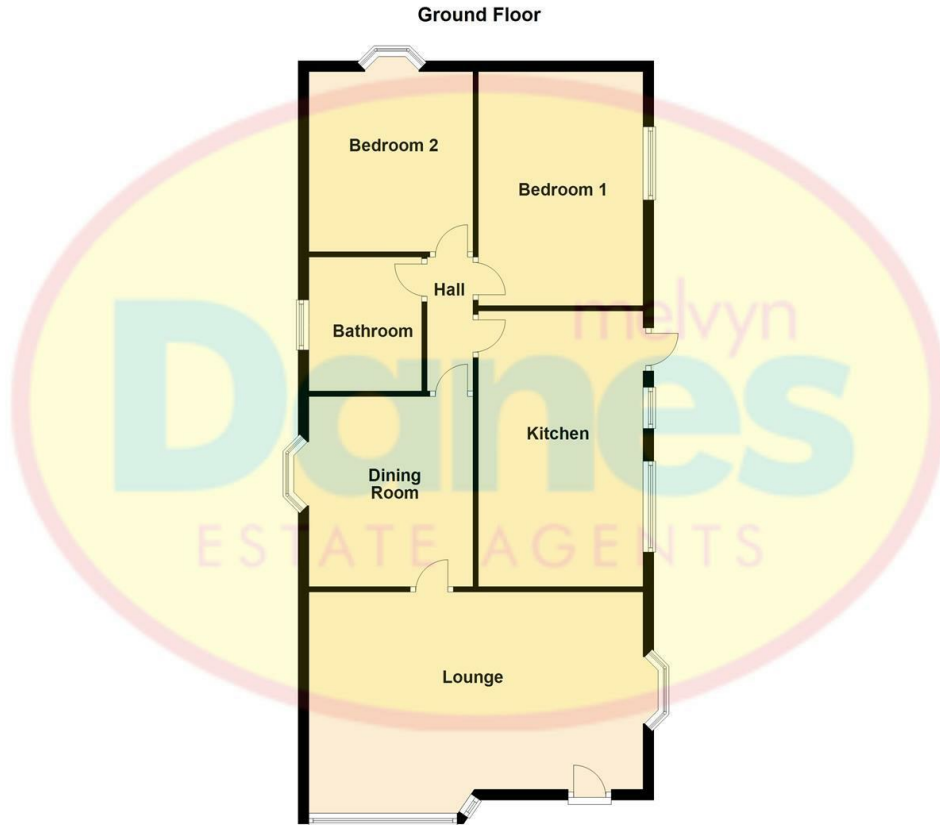

**VIEWING:** By appointment only with the office on the number below.

**SITE FEES** We are advised that site fees are currently around £192.90 per calendar month.

**COUNCIL TAX BAND:** A

**CONSUMER PROTECTION FROM UNFAIR TRADING REGULATIONS 2008:** These particulars are for general guidance only and are based on information supplied and approved by the seller. Complete accuracy cannot be guaranteed and may be subject to errors and/or omissions. They do not constitute representations of fact or form part of any offer or contract. Any Prospective Purchaser should obtain verification of all legal and factual matters and information from their Solicitor, Licensed Conveyancer or Surveyors as appropriate. The agent has not sought to verify the legal title of the property and the buyers must obtain verification from their solicitor. Photographs are provided for illustrative purposes only and the items shown in these are not necessarily included in the sale, unless specifically stated. The agent has not tested any apparatus, equipment, fixtures, fittings or services mentioned and do not by these Particulars or otherwise verify or warrant that they are in working order.

**MONEY LAUNDERING REGULATIONS:** Intending purchasers will be asked to produce identification documentation at a later stage and we would ask for your co-operation in order that there will be no delay in agreeing the sale.

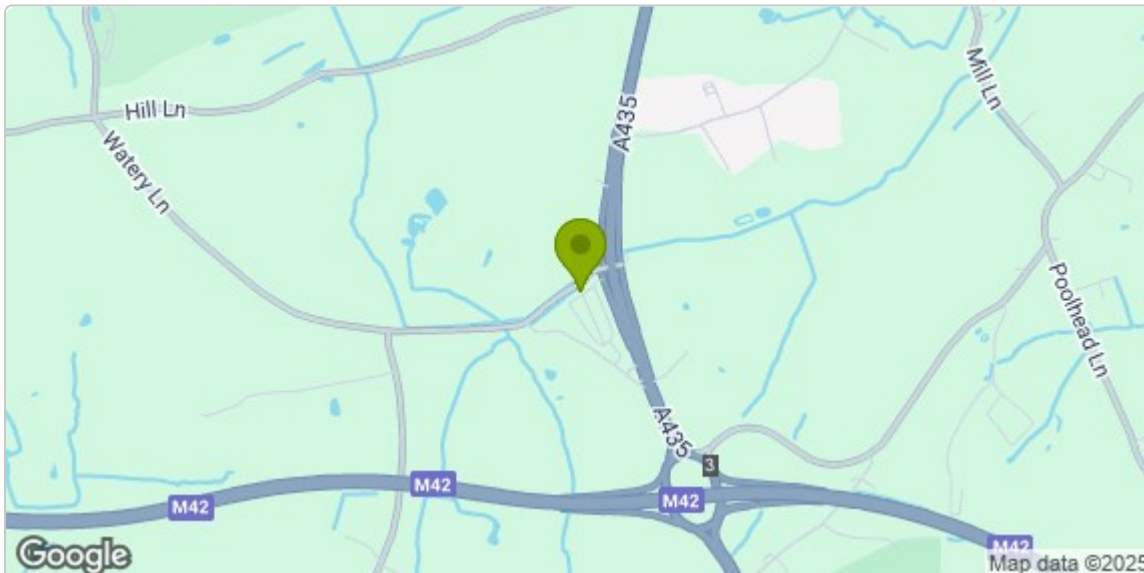

**Full Postal Address:**  
8 Ash Crescent Hillcrest Park  
Wythall B47 6DU

**Council Tax Band:** A

Energy Efficiency Rating		
	Current	Potential
Very energy efficient - lower running costs		
(92 plus) <b>A</b>		
(81-91) <b>B</b>		
(69-80) <b>C</b>		
(55-68) <b>D</b>		
(39-54) <b>E</b>		
(21-38) <b>F</b>		
(1-20) <b>G</b>		
Not energy efficient - higher running costs		
<b>England &amp; Wales</b>	EU Directive 2002/91/EC	